

Architectural Code for Old Fort Bay

Neighborhood

RIDGE LOT

BUILDABLE AREA

Area of the parcel where the house can be built.

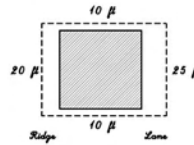

YARDS

An open space free of structures. (Except Pavilions, Cottages, and Parking Structures)

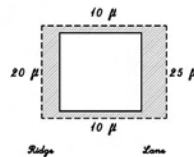

PAVILIONS AND COTTAGES

A "Pavilion" is a light, sometimes ornamental roofed structure, used for amusement or shelter.

A "Cottage" is a small ancillary structure used for dwelling.

(Allowable in hatched areas)

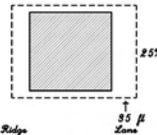

Max. footprint of structure not to exceed 25% of hatched area.

GARDEN WALLS, FENCES AND HEDGES

Walls built on property lines. (Allowable in hatched area)

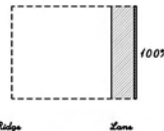

Max. Vehicular Opening 12 ft. Gate and Entry Pillars Required. Allow 15% Tree Removal for Driveway.

BUILDING HEIGHT

Vertical dimension of building in number of stories.



PARKING, DRIVEWAYS AND DOCKS

"Parking structure" is where vehicles are stored. A "Driveway" is a road leading up to a private house or parking structure.

(Allowable in Hatched Areas)

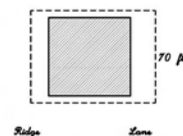



Click here to review: [Harc Building Requirements](#)